

Base Rails



Universal Base Rails and Install Kits (Universal 4-Bolt/10-Bolt Rails)

30686 UNIVERSAL BASE RAILS—The perfect rails for installing fifth wheel hitches, in a 4-Bolt or 10-Bolt application. Can be used with all Husky fifth wheel products and requires the use of a Husky install kit. Finish is durable black powdered coat.
You must order either a custom bracket kit OR the 31622 10-Bolt Universal Install Kit for 10-Bolt installations, or use the 31563 4-Bolt Kit for 4-Bolt Installations.



Universal Install Kit (4-Bolt 31563 pictured)



Description	Part #
UNIVERSAL BASE RAIL KIT — FULL SIZE PICKUPS, 6-1/2' & 8' Bed Lengths	
Universal 4-Bolt/10-Bolt Base Rails; Includes Two Base Rails only — requires an Install Kit (below) or a Custom Bracket Kit (next page), sold separately	30686
Universal Install Kit for 10-Bolt Base Rails (Angle brackets and associated hardware in one box for installations on most applications (requires drilling))	31622
Universal Install Kit for 4-Bolt Base Rails (Four angle brackets and associated hardware in one box for installation on most applications (requires drilling))	31563

Custom Bracket Kits for Base Rails

For the perfect fit, use Husky Base Rails with one of the the Custom Bracket Kits on the next page to fit your truck to the Husky Fifth Wheel Hitch, Glider, and Gooseneck Hitches. Bracket Kits come with hardware and easy-to-install instructions. Custom brackets significantly reduce installation time and guarantee an exact fit for your pickup. Some clamp-on and bolt-on brackets require **no drilling** into the truck frame when using 4-bolt Base Rails, and all attachment types are designed for the best possible installation. *See next page.*

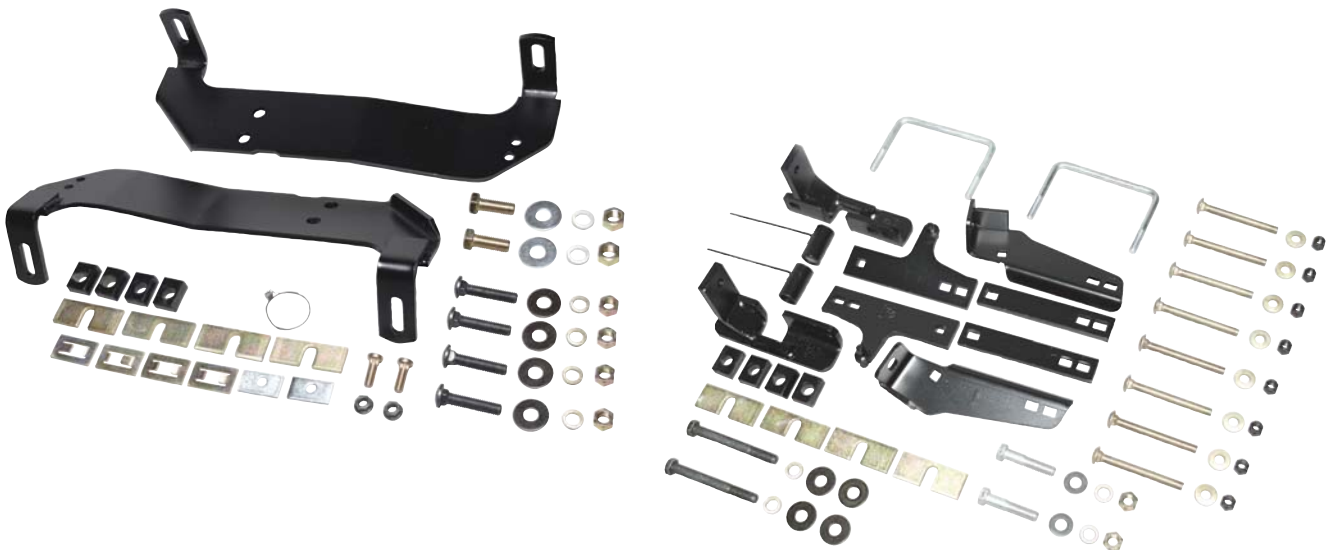

Husky Custom Bracket Kits are used with Base Rails for an exact fit and reduced installation time, and include hardware and easy-to-follow instructions

Base Rails



CUSTOM BRACKET KITS, REQUIRED FOR USE WITH 31323 4-BOLT OR 30686 UNIVERSAL 10 BOLT BASE RAILS						Bracket Part #
Year	Make	Pickup Model	Bed L	Attachment Type		
07-13	Chev/GMC	Silverado/Sierra 1500 New Body	6-1/2' & 8'	Custom brackets, drilling required		31396
2014	Chev/GMC	Silverado/Sierra 1500 New Body (Long bed ONLY) (except Double & Crew Cabs)	8'	Custom brackets, drilling required		31396
99-10	Chev/GMC	Silverado/Sierra, All (incl. up to 07 Classic) + 07-09 2500HD & 3500	6-1/2' & 8'	Custom brackets, drilling required		31415
01-10	Chev/GMC	2500/3500 with or w/o Integrated Brake Control + 99-07 Classic 1500	6-1/2' & 8'	Custom brackets, drilling required		31397
11-15	Chev/GMC	Pickup 2500/3500	6-1/2' & 8'	Custom brackets, no drill (frame) Bolt-on		31852
11-15	Chev/GMC	Pickup 2500/3500	6-1/2' & 8'	Custom brackets, drilling required Bolt-on		31853
88-98	Chev/GMC	C/K Pickup 1500, 88-99 C/K Pickup 2500/3500	6-1/2' & 8'	Custom brackets, drilling required		31402
73-87	Chev/GMC	Pickup	6-1/2' & 8'	Universal bracket kit, drilling required		31563
07-08	Dodge	Ram Pickup 1500	6-1/2' & 8'	Custom brackets, drilling required		31565
07-08	Dodge	Ram Pickup 1500	6-1/2' & 8'	Custom brackets, no drill clamp-on		31413
09-14	Dodge	Ram Pickup 1500 (incl. ECO Diesel) (Except '13-14 Factory Air Suspension)	6-1/2' & 8'	Custom brackets, no drill (frame) clamp-on		31566
02-06	Dodge	Ram Pickup 1500, plus 06 1500 Mega Cab	6-1/2' & 8'	Custom brackets, drilling required		31565
03-09	Dodge	Ram Pickup 2500, 3500 (except 3500HD 4WD)	6-1/2' & 8'	Custom brackets, drilling required		31565
03-12	Dodge	Ram Pickup 2500, 3500	6-1/2' & 8'	Custom brackets, no drill (frame) clamp-on		31413
2013	Dodge	Ram Pickup 2500 ONLY, all models	6-1/2' & 8'	Custom brackets, drilling required		32084
13-14	Dodge	NEW! Ram Pickup 3500 ONLY, all models	6-1/2' & 8'	Custom brackets, drilling required		32221
02-06	Dodge	Ram Pickup 1500 (Except '06 1500 non-Mega Cab)	6-1/2' & 8'	Custom brackets, no drill , clamp-on		31413
94-02	Dodge	Ram PU, All (except 2002 1500)	6-1/2' & 8'	Custom brackets, drilling required		31404
93-Older	Dodge	Ram Pickup	6-1/2' & 8'	Universal bracket kit, drilling required		31563
04-14	Ford	F-150 (Clamp On) (New Body Style)	6-1/2' & 8'	Custom brackets, no drill , clamp-on		31564
05-15	Ford	F-250/350 plus 08-09 F-450 Super Duty	6-1/2' & 8'	Custom brackets, drilling required		31412
08-15	Ford	F-250/350/450 Super Duty	6-1/2' & 8'	Custom brackets, drilling required		31408
99-07	Ford	F-250/350 Super Duty	6-1/2' & 8'	Custom brackets, no drill (frame), bolt-on		31407
99-04	Ford	F-250/350 Super Duty	6-1/2' & 8'	Four bolt drill. Top frame rail mounting		31405
99-04	Ford	F-250/350 Super Duty	6-1/2' & 8'	Custom brackets, drilling required		31406
97-04	Ford	F150 Heritage (old body)	6-1/2' & 8'	Custom brackets, drilling required		31409
98-Older	Ford	F250HD / F350, plus 96-Older F150 / 250	6-1/2' & 8'	Universal bracket kit, drilling required		31563
04-09	Nissan	Titan King Cab plus 08-09 Titan Crew Cab Pickup	6-1/2' & 8'	Custom brackets, drilling required		31395
07-14	Toyota	Tundra Pickup	6-1/2' & 8'	Custom brackets, drilling required		31410
99-06	Toyota	Tundra Pickup	6-1/2' & 8'	Universal bracket kit, drilling required		31563
		Universal Style, for Older Full Size Pickups	6-1/2' & 8'	See www.huskytow.com for fits; drilling required		31563
4 BOLT BASE RAIL ADAPTER BRACKET KITS. These kits require the purchase of Universal Kit 31563.						
09-14	Dodge	Ram Pickup 1500 4-Bolt Adapter Kit	6-1/2' & 8'	Adapter brackets for 4-Bolt Kit; drilling required		30665
02-08	Dodge	Ram Pickup Full Size 1500 (except Mega Cab)	6-1/2' & 8'	Adapter brackets for 4-Bolt Kit; drilling required		30640
02-13	Dodge	Ram Pickup Full Size 2500 (except Mega Cab)	6-1/2' & 8'	Adapter brackets for 4-Bolt Kit; drilling required		30607
02-12	Dodge	Ram Pickup Full Size 3500 (except Mega Cab)	6-1/2' & 8'	Adapter brackets for 4-Bolt Kit; drilling required		30607
96-Older	Ford	F-150	6-1/2' & 8'	Adapter brackets for 4-Bolt Kit; drilling required		30607
97-Older	Ford	F-250/350	6-1/2' & 8'	Adapter brackets for 4-Bolt Kit; drilling required		30607
99-15	Ford	F-250/350/450 Super Duty (minus chassis cab)	6-1/2' & 8'	Adapter brackets for 4-Bolt Kit; drilling required		30607
10 BOLT BASE RAIL ADAPTER BRACKET KITS. These kits require the purchase of Universal Kit 31622.						
02-08	Dodge	1500 10-Bolt Kit	6-1/2' & 8'	Adapter bracket for 10-Bolt Kit; drilling required		30562
03-12	Dodge	2500/3500 10-Bolt Kit	6-1/2' & 8'	Adapter bracket for 10-Bolt Kit; drilling required		30582
07-14	Toyota	Tundra 10-Bolt Tube Spacer Kit	6-1/2' & 8'	Spacer tubes for 10-Bolt Kit; drilling required		30600
00-06	Toyota	Tundra 10-Bolt Tube Spacer Kit	6-1/2' & 8'	Spacer tubes for 10-Bolt Kit; drilling required		30597
ADAPTER BRACKET KIT; FITS BOTH 4-BOLT & 10-BOLT BASE RAILS. Requires the purchase of Universal Kit 31622 or 31563.						
04-14	Ford	F150 Kit 10-Bolt/4-Bolt	6-1/2' & 8'	Custom brackets for 4- & 10-Bolt Kit; drilling required		30619

Additional Brackets & Hardware	Qty/Hitch	Part #
Custom Bracket Kit for use with 31404; Fits Dodge 02-05 Ram PU 1500, 03-05 2500, 6-1/2' & 8' Bed	1	31414
Straight "L" Bracket Service Kit	1	31385
Left and Right Angle Bracket Replacement Kit	1	31401
Hardware Service Kit for 31563 Bracket Kit.	1	31418
Spacer Tube Kit for 31622 kit. (Used on 02-08 1500 Dodge PU, 03-10 2500/3500 Dodge PU, 6-1/2' & 8' Bed)	1	30575
Base Rail 1/4" Spacer Kit	1	31419
NEW! Base Rail Tall Spacer Block Kit, Bag/4	1	31712

Additional Brackets & Hardware	Qty/Hitch	Part #
Wheel Bolt Kit Pkg/8	1 Pk	31417
Center Bolt Kit to use with 20K, 25K, 26K Fifth Wheel Hitches and Rollers (Black Series only)	1	053362
Center Bolt Kit to use with Black or Silver Series Fifth Wheel Hitches and Rollers	1	32059
NEW! 32221 Dodge Ram 3500 U-Bolt Service Kit	1	32222
NEW! 32221 Dodge Ram 3500 Hardware Service Kit (spacers 32224 & U-Bolts; 32222 NOT included)	1	32223
NEW! 32221 Dodge Ram 3500 Spacer Service Kit	1	32224